

FORM NO 1.

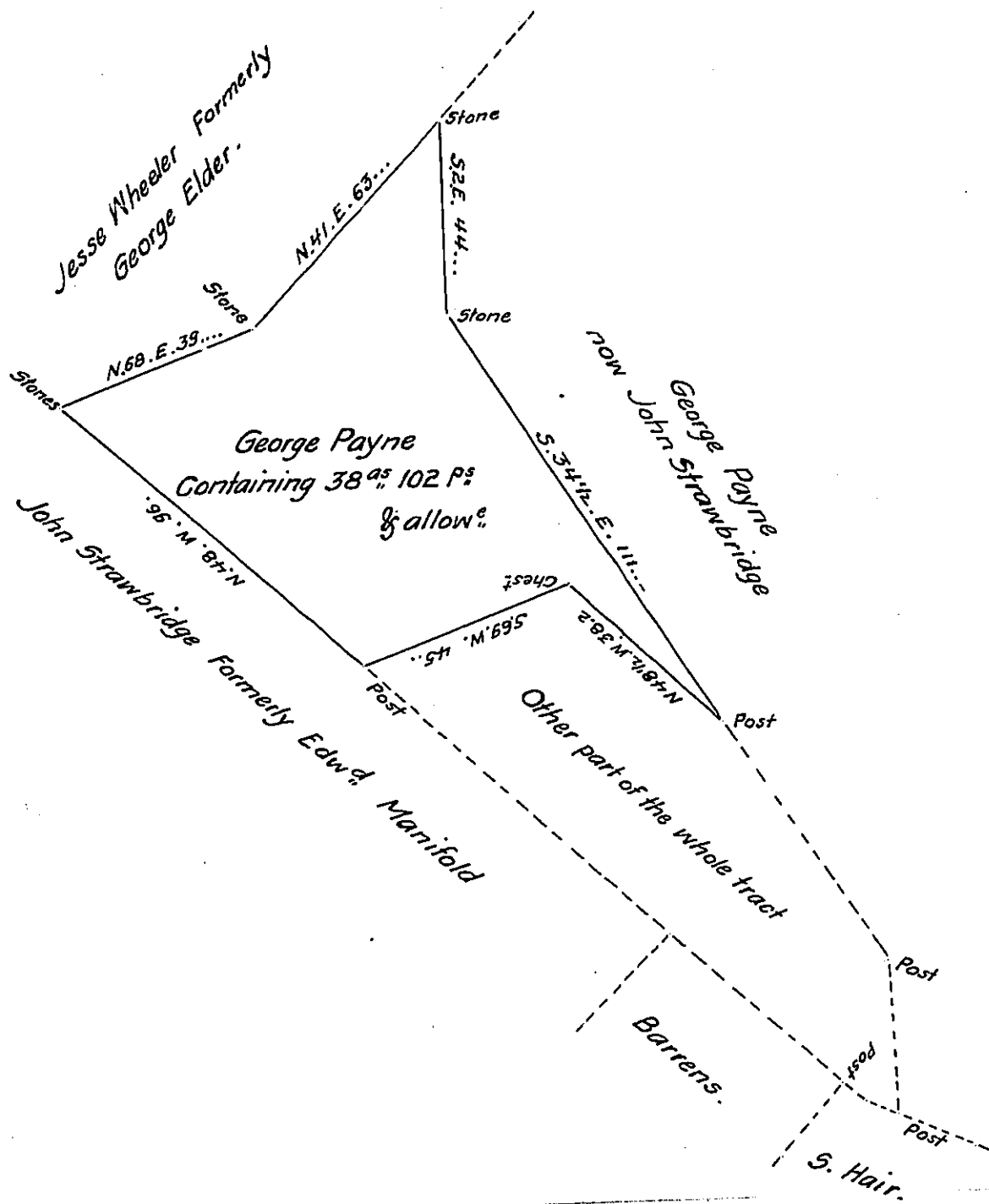

Situate in Fawn township in the County of York Containing as above set forth <sup>as</sup> 38.102 perches and allowance &c.<sup>a</sup>. Being part of a larger tract of land originally Surveyed by William Matthews then D.S. on the 29<sup>th</sup> day of the 5<sup>th</sup> month 1767. for George Payne in pursuance of his Application. N<sup>o</sup> 3155. dated the 23<sup>d</sup> day of March 1767. Resurveyed & Divided off from said larger tract of land the 13<sup>th</sup> day of March 1827. at the request of John Strawbridge the present owner of said part who desired the same to be returned for confirmation.

To Gabriel Hiester Esq<sup>r</sup> }  
 Surveyor General.

Dan<sup>l</sup> Small D.S.

IN TESTIMONY that the above is a copy of the original remaining on file in the Department of Internal Affairs of Pennsylvania, made conformably to an Act of Assembly approved the 16th day of February, 1833, I have hereunto set my Hand and caused the Seal of said Department to be affixed at Harrisburg, this seventeenth day of July 1908

*Henry Howard*  
 Secretary of Internal Affairs.